



City of Westminster

Licensing Sub-Committee Report

Item No:	
Date:	10 November 2016
Licensing Ref No:	16/09678/LIPV - Premises Licence Variation
Title of Report:	Pepe Italian Street Food Basement and Ground Floor 27 Old Compton Street London W1D 5JP
Report of:	Director of Public Protection and Licensing
Wards involved:	West End
Policy context:	City of Westminster Statement of Licensing Policy
Financial summary:	None
Report Author:	Mr Nick Nelson Senior Licensing Officer
Contact details	Telephone: 020 7641 3431 Email: nnelson@westminster.gov.uk

1. Application

1-A Applicant and premises			
Application Type:	Variation of a Premises Licence, Licensing Act 2003		
Application received date:	13 September 2016		
Applicant:	La Trebbia Ltd		
Premises:	Pepe Italian Street Food		
Premises address:	Basement and Ground Floor 27 Old Compton Street London W1D 5JP	Ward:	West End
		Cumulative Impact Area:	West End
Premises description:	The premises operates as a restaurant over the ground floor and basement.		
Variation description:	To extend the hours for recorded music, late night refreshment and the closing hours from Thursday to Saturday until 03.00am.		
Premises licence history:	The premises has held a licence under the Licensing Act 2003 since at least 2005 and was previously known as Opuz Kitchen. The current licence holder has held the licence since 25 January 2016.		

1-B Current and proposed licensable activities, areas and hours						
Regulated Entertainment						
Playing of recorded music						
	Current Hours		Proposed Hours		Licensable Area	
	Start:	End:	Start:	End:	Current:	Proposed:
Monday	10:00	00:00	No change		Ground floor and basement	No change
Tuesday	10:00	00:00	No change		Ground floor and basement	No change
Wednesday	10:00	00:00	No change		Ground floor and basement	No change
Thursday	10:00	00:00	No change	03:00	Ground floor and basement	No change
Friday	10:00	00:00	No change	03:00	Ground floor and basement	No change
Saturday	10:00	00:00	No change	03:00	Ground floor and basement	No change
Sunday	12:00	23:30	No change	00:00	Ground floor and basement	No change

Seasonal variations:	Current:	Proposed:
	None	No change
Non-standard timings:	Current:	Proposed:
	New Year's Eve from 10:00 hours to the commencement of permitted hours New Year's Day	No change

Late night refreshment						
Indoors, outdoors or both		Current :			Proposed:	
		Both			No change	
	Current Hours		Proposed Hours		Licensable Area	
	Start:	End:	Start:	End:	Current:	Proposed:
Monday	23:00	00:30	No change		Ground floor and basement	No change
Tuesday	23:00	00:30	No change		Ground floor and basement	No change
Wednesday	23:00	00:30	No change		Ground floor and basement	No change
Thursday	23:00	01:00	No change	03:00	Ground floor and basement	No change
Friday	23:00	01:00	No change	03:00	Ground floor and basement	No change
Saturday	23:00	01:00	No change	03:00	Ground floor and basement	No change
Sunday	23:00	00:00	No change		Ground floor and basement	No change
Seasonal variations/ Non-standard timings:	Current:			Proposed:		
	None			No change		
	The terminal hour for late night refreshment on New Year's Eve is extended to 05:00 on New Year's Day.			No change		

Sale by Retail of Alcohol						
On or off sales		Current :			Proposed:	
		Both			No change	
	Current Hours		Proposed Hours		Licensable Area	
	Start:	End:	Start:	End:	Current:	Proposed:
Monday	10:00	00:00	No change		Ground floor and basement	No change
Tuesday	10:00	00:00	No change		Ground floor and basement	No change
Wednesday	10:00	00:00	No change		Ground floor and basement	No change
Thursday	10:00	00:00	No change		Ground floor and basement	No change

Friday	10:00	00:00	No change	Ground floor and basement	No change
Saturday	10:00	00:00	No change	Ground floor and basement	No change
Sunday	12:00	23:30	No change	Ground floor and basement	No change
Seasonal variations/ Non-standard timings:	Current:			Proposed:	
	None			No change	
	New Year's Eve from end of permitted hours to the start of permitted hours on the following day			No change	

Hours premises are open to the public						
	Current Hours		Proposed Hours		Premises Area	
	Start:	End:	Start:	End:	Current:	Proposed:
Monday	08:00	00:30	No change		Ground floor and basement	No change
Tuesday	08:00	00:30	No change		Ground floor and basement	No change
Wednesday	08:00	00:30	No change		Ground floor and basement	No change
Thursday	08:00	01:00	No change	03:00	Ground floor and basement	No change
Friday	08:00	01:00	No change	03:00	Ground floor and basement	No change
Saturday	08:00	01:00	No change	03:00	Ground floor and basement	No change
Sunday	10:00	00:00	No change		Ground floor and basement	No change
Seasonal variations/ Non-standard timings:	Current:			Proposed:		
	None			No change		
	None			No change		

Adult entertainment:	Current position:	Proposed position:
	None	No change

2. Representations

2-A Responsible Authorities	
Responsible Authority:	Environmental Health
Representative:	Mrs Nicola Curtis
Received:	4 October 2016
I wish to make the following representations in relation to the above application:	

1. The proposed extension of the terminal hour for the Provision of Recorded Music 'indoors' is outside of Westminster Licensing Policy, and will have the likely effect of causing an increase in Public Nuisance in the West End Cumulative Impact area.

2. The proposed extension of the terminal hour for the Provision of Late Night Refreshment both 'indoors' and 'outdoors' is outside of Westminster Licensing Policy, and will have the likely effect of causing an increase in Public Nuisance in the West End Cumulative Impact area.

The granting of the variation where representation is made would have the likely effect of causing an increase of Public Nuisance in the West End Cumulative Impact Area.

Environmental Health have proposed one additional condition, as well as the replacement of two existing conditions and the removal of one condition from the licence (see **Appendix 4**).

Responsible Authority:	Metropolitan Police
-------------------------------	---------------------

Representative:	PC Sandy Russell
------------------------	------------------

Received:	23 September 2016
------------------	-------------------

With reference to the above application, I am writing to inform you that the Metropolitan Police, as a responsible authority, will be objecting to this application. It is our belief that if granted the application would undermine the Licensing Objectives. The premises are situated within the West Cumulative Impact area.

Following a site visit to the premises, the Police have proposed four conditions (see **Appendix 4**).

Responsible Authority:	Licensing Authority
-------------------------------	---------------------

Representative:	Mr Steven Rowe
------------------------	----------------

Received:	10 October 2016
------------------	-----------------

As a responsible authority under section 13 (4) of the Licensing Act 2003 as amended under the Police and Social Responsibility Act 2011 the Licensing Authority have considered your application in full. The Licensing Authority has concerns in relation to this application and how the premises would promote the Licensing Objectives:

- Public Nuisance
- Prevention of Crime & Disorder
- Public Safety
- Protection of Children from Harm

The application currently contains insufficient information to enable the Licensing Authority to make a suitable assessment. However, as it stands the application does contravene Westminster's Statement of Licensing Policies CIP1, RNT2 and HRS1. The application is requesting to increase the terminal hour for recorded music inside the premises from 00:00 to 03:00 on each of the days Thursday to Saturday and from 23:30 to 00:00 on Sunday and also increase the terminal hour for Late Night Refreshment

from 01:00 to 03:00 on each of the days Thursday to Saturday. The premises is located inside the Cumulative Impact Area.

Policy CIP1 states (i) It is the Licensing Authority's policy to refuse applications in the Cumulative Impact Areas for: pubs and bars, fast food premises, and premises offering facilities for music and dancing; other than applications to vary hours within the Core Hours under Policy HRS1.

However part (ii) states: Applications for other licensable activities in the Cumulative Impact Areas will be subject to other policies, and must demonstrate that they will not add to cumulative impact in the Cumulative Impact Areas.

Policy HRS1 states at paragraph 2.3.2: "It is the intention to generally grant licences... where the hours when customers are permitted to be on the premises are within the 'core hours' as set out in Policy HRS1. This is not a policy to refuse applications for longer hours than the core hours and consideration will in all cases be given to the individual merits of an application.

Where a proposal is made to operate outside these core hours each application will be considered on its merits against the criteria as set out in paragraph (ii) (of Policy HRS1)".

The current application for the extension of hours further departs from core hours:

Late Night Refreshment:

Thursday to Saturday a proposed extension of 2 hours resulting in 3 ½ hours beyond 'core hours' on Thursday and 3 hours beyond 'core hours' on Friday and Saturday

Recorded Music:

Thursday to Saturday a proposed extension of 3 hours resulting in 3 ½ hours beyond 'core hours' on Thursday and 3 hours beyond 'core hours' on Friday and Saturday and on Sunday a proposed extension of 30 minutes resulting in 1 ½ hours beyond 'core hours'.

Policy RNT2 which relates to restaurants within the CIA states 'Applications will be granted subject to other policies in this Statement and subject to the relevant criteria in Policies CD1, PS1, PN1 and CH1, provided it can be demonstrated that they will not add to cumulative impact in the Cumulative Impact Areas.

Please therefore accept this as a formal representation, further details will be provided in due course including a discussion relating to conditions.

3. Policy & Guidance

The following policies within the City Of Westminster Statement of Licensing Policy apply:

Policy HRS1 applies	(i) Applications for hours within the core hours in this policy will generally be granted, subject to not being contrary to other policies in the Statement of Licensing Policy.
----------------------------	--

	(ii) Applications for hours outside the core hours in this policy will be considered on their merits, subject to other relevant policies and with particular regard to the criteria specified.
Policy CIP1 applies	<p>(i) It is the Licensing Authority's policy to refuse applications in the Cumulative Impact Areas for: pubs and bars, fast food premises, and premises offering facilities for music and dancing; other than applications to vary hours within the Core Hours under Policy HRS1.</p> <p>(ii) Applications for other licensable activities in the Cumulative Impact Areas will be subject to other policies, and must demonstrate that they will not add to cumulative impact in the Cumulative Impact Areas.</p>
Policy RNT2 applies	Applications will be granted subject to other policies in this Statement and subject to the relevant criteria in Policies CD1, PS1, PN1 and CH1, provided it can be demonstrated that they will not add to cumulative impact in the Cumulative Impact Areas.

4. Appendices

Appendix 1	Premises plans
Appendix 2	Applicant supporting documents - none
Appendix 3	Premises history
Appendix 4	Proposed conditions
Appendix 5	Residential map and list of premises in the vicinity

Report author:	Mr Nick Nelson Senior Licensing Officer
Contact:	Telephone: 020 7641 3431 Email: nnelson@westminster.gov.uk

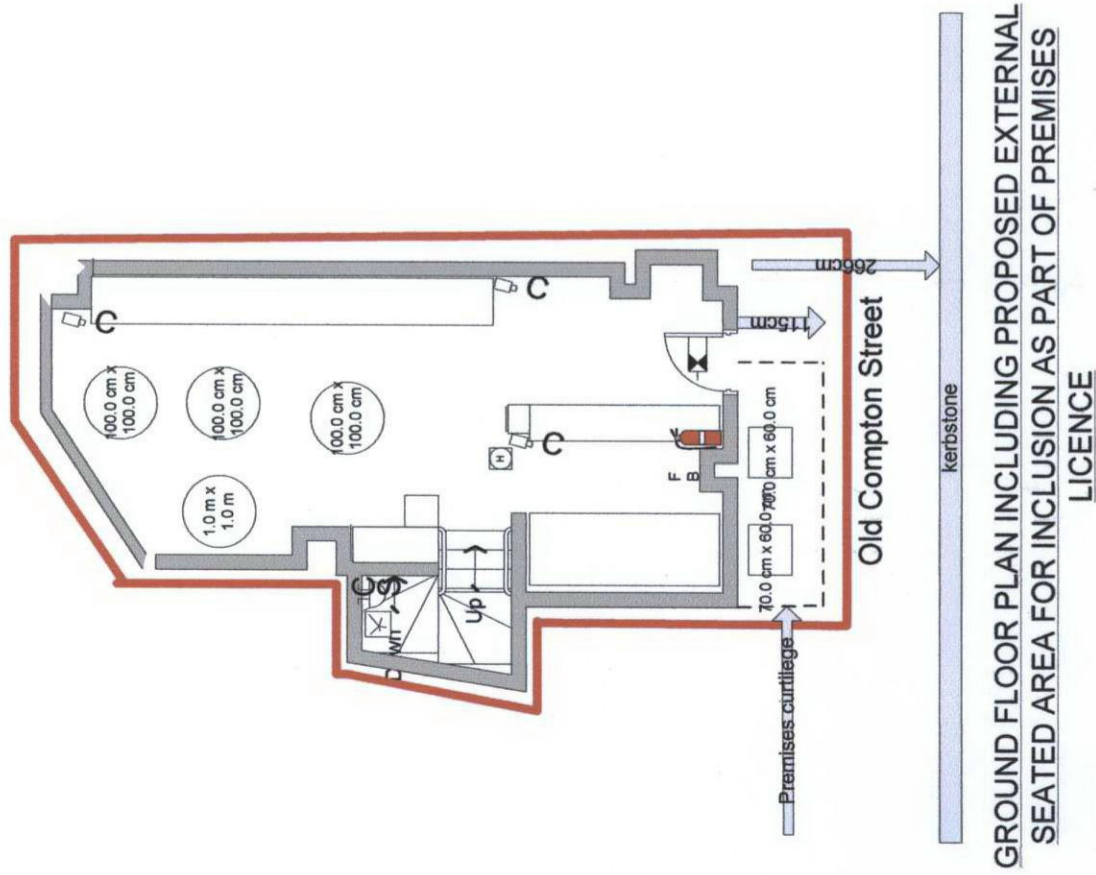

GROUND FLOOR PLAN INCLUDING PROPOSED EXTERNAL SEATED AREA FOR INCLUSION AS PART OF PREMISES LICENCE



BASEMENT FLOOR PLAN

Key

Fire alarm call point

Fire exit signage

Mechanical smoke extraction

Fire extinguisher

Fire blanket

Smoke detector

CCTV Camera

CCTV Monitor

Ambit of licensed area

Proposed area for inclusion
As part of premises licence
(Denotes two tables 4 chairs)



MSE Equipment



F B



Anthony O'Connell
A&R Consultants
07843 555827
10.06.2010
Ref: A&R/OPUZK/1

SCALE: 1:100

Licence & Appeal History

Application	Details of Application	Date Determined	Decision
05/07044/LIPCV Conversion application	Application to convert the Justices licence under the Licensing Act 2003	30.09.2005	Granted under delegated authority Licence surrendered on 10.03.2009
09/09421/LIPN New application	Application for a new premises licence	21.01.2010	Granted by Licensing Sub-Committee
10/05723/LIPV Variation application	Application to vary the licensable area of the premises licence	07.09.2010	Granted under delegated authority
16/00887/LIPT Transfer application	Application to transfer the premises licence from Mr Ibrahim Opuz to La Trebbia Ltd	19.02.2016	Granted under delegated authority
16/03145/LIPDPS DPS variation	Application to change the designated premises supervisor	15.04.2016	Granted under delegated authority
16/04918/LIPCHT Change of details	Application to change the trading name of the premises	16.05.2016	Granted under delegated authority

There is no appeal history

CONDITIONS CONSISTENT WITH THE OPERATING SCHEDULE AND CONDITIONS PROPOSED BY A PARTY TO THE HEARING

When determining an application for a new premises licence under the provisions of the Licensing Act 2003, the licensing authority must, unless it decides to reject the application, grant the licence subject to the conditions which are indicated as mandatory in this schedule.

At a hearing the licensing authority may, in addition, and having regard to any representations received, grant the licence subject to such conditions which are consistent with the operating schedule submitted by the applicant as part of their application, or alter or omit these conditions, or add any new condition to such extent as the licensing authority considers appropriate for the promotion of the licensing objectives.

This schedule lists those conditions which are consistent with the operating schedule, or proposed as appropriate for the promotion of the licensing objectives by a responsible authority or an interested party as indicated. These conditions have not been submitted by the licensing service but reflect the positions of the applicant, responsible authority or interested party and have not necessarily been agreed

Conditions: On Current Licence -

Mandatory:

1. No supply of alcohol may be made at a time when there is no designated premises supervisor in respect of this licence.
2. No supply of alcohol may be made at a time when the designated premises supervisor does not hold a personal licence or the personal licence is suspended.
3. Every supply of alcohol under this licence must be made or authorised by a person who holds a personal licence.
4. (1) The responsible person must ensure that staff on relevant premises do not carry out, arrange or participate in any irresponsible promotions in relation to the premises.

(2) In this paragraph, an irresponsible promotion means any one or more of the following activities, or substantially similar activities, carried on for the purpose of encouraging the sale or supply of alcohol for consumption on the premises—
 - (a) games or other activities which require or encourage, or are designed to require or encourage, individuals to;
 - (i) drink a quantity of alcohol within a time limit (other than to drink alcohol sold or supplied on the premises before the cessation of the period in which the responsible person is authorised to sell or supply alcohol), or
 - (ii) drink as much alcohol as possible (whether within a time limit or otherwise);

- (b) provision of unlimited or unspecified quantities of alcohol free or for a fixed or discounted fee to the public or to a group defined by a particular characteristic in a manner which carries a significant risk of undermining a licensing objective;
 - (c) provision of free or discounted alcohol or any other thing as a prize to encourage or reward the purchase and consumption of alcohol over a period of 24 hours or less in a manner which carries a significant risk of undermining a licensing objective;
 - (d) selling or supplying alcohol in association with promotional posters or flyers on, or in the vicinity of, the premises which can reasonably be considered to condone, encourage or glamorise anti-social behaviour or to refer to the effects of drunkenness in any favourable manner;
 - (e) dispensing alcohol directly by one person into the mouth of another (other than where that other person is unable to drink without assistance by reason of a disability).
5. The responsible person must ensure that free potable water is provided on request to customers where it is reasonably available.
6. (1) The premises licence holder or club premises certificate holder must ensure that an age verification policy is adopted in respect of the premises in relation to the sale or supply of alcohol.
- (2) The designated premises supervisor in relation to the premises licence must ensure that the supply of alcohol at the premises is carried on in accordance with the age verification policy.
- (3) The policy must require individuals who appear to the responsible person to be under 18 years of age (or such older age as may be specified in the policy) to produce on request, before being served alcohol, identification bearing their photograph, date of birth and either—
- (a) a holographic mark, or
 - (b) an ultraviolet feature.
7. The responsible person must ensure that—
- (a) where any of the following alcoholic drinks is sold or supplied for consumption on the premises (other than alcoholic drinks sold or supplied having been made up in advance ready for sale or supply in a securely closed container) it is available to customers in the following measures—
 - (i) beer or cider: ½ pint;
 - (ii) gin, rum, vodka or whisky: 25 ml or 35 ml; and
 - (iii) still wine in a glass: 125 ml;

- (b) these measures are displayed in a menu, price list or other printed material which is available to customers on the premises; and
- (c) where a customer does not in relation to a sale of alcohol specify the quantity of alcohol to be sold, the customer is made aware that these measures are available.

A responsible person in relation to a licensed premises means the holder of the premise licence in respect of the premises, the designated premises supervisor (if any) or any individual aged 18 or over who is authorised by either the licence holder or designated premises supervisor. For premises with a club premises certificate, any member or officer of the club present on the premises in a capacity that which enables him to prevent the supply of alcohol.

8(i) A relevant person shall ensure that no alcohol is sold or supplied for consumption on or off the premises for a price which is less than the permitted price.

8(ii) For the purposes of the condition set out in paragraph 8(i) above -

- (a) "duty" is to be construed in accordance with the Alcoholic Liquor Duties Act 1979;
- (b) "permitted price" is the price found by applying the formula -

$$P = D + (D \times V)$$

Where -

- (i) P is the permitted price,
 - (ii) D is the amount of duty chargeable in relation to the alcohol as if the duty were charged on the date of the sale or supply of the alcohol, and
 - (iii) V is the rate of value added tax chargeable in relation to the alcohol as if the value added tax were charged on the date of the sale or supply of the alcohol;
- (c) "relevant person" means, in relation to premises in respect of which there is in force a premises licence -
- (i) the holder of the premises licence,
 - (ii) the designated premises supervisor (if any) in respect of such a licence, or
 - (iii) the personal licence holder who makes or authorises a supply of alcohol under such a licence;
- (d) "relevant person" means, in relation to premises in respect of which there is in force a club premises certificate, any member or officer of the club present on the premises in a capacity which enables the member or officer to prevent the supply in question; and

- (e) "value added tax" means value added tax charged in accordance with the Value Added Tax Act 1994.
- 8(iii). Where the permitted price given by Paragraph 8(ii)(b) above would (apart from this paragraph) not be a whole number of pennies, the price given by that sub-paragraph shall be taken to be the price actually given by that sub-paragraph rounded up to the nearest penny.
- 8(iv).
 - (1) Sub-paragraph 8(iv)(2) below applies where the permitted price given by Paragraph 8(ii)(b) above on a day ("the first day") would be different from the permitted price on the next day ("the second day") as a result of a change to the rate of duty or value added tax.
 - (2) The permitted price which would apply on the first day applies to sales or supplies of alcohol which take place before the expiry of the period of 14 days beginning on the second day.

Annex 2 – Conditions consistent with the operating Schedule

- 9. Alcohol consumed outside the premises building shall only be consumed by patrons seated at tables and as an ancillary to their meal.
- 10. Outside tables and chairs shall be removed at 23.00hrs.
- 11. Notices shall be prominently displayed at any area used for smoking requesting patrons to respect the needs of local residents and use the area quietly.
- 12. Chelsea clips (bag security hooks) shall be attached underneath each outside table.
- 13. There shall be no vertical drinking outside the premises.

Annex 3 – Conditions attached after a hearing by the licensing authority

- 14. This licence is subject to all the former regulations made by Westminster City Council prescribing standard conditions for annual night café licences, effective from 1 October 2001.

Environmental Health have proposed this condition be removed from the licence as it is no longer relevant.

- 15. The number of persons accommodated at any one time (excluding staff) shall not exceed 20.
- 16. The terminal hour for late night refreshment on New Year's Eve is extended to 05:00 on New Year's Day.
- 17. The premises shall install and maintain a comprehensive CCTV system as per the minimum requirements of a Metropolitan Police Crime Prevention Officer. All entry and exit points will be covered enabling frontal identification of every person entering in any light condition. The CCTV system shall continually record whilst the premises is open for licensable activities and during all times when customers remain on the premises. All recordings shall be stored for a minimum

period of 31 days with date and time stamping. Recordings shall be made available immediately upon the request or authorised officer throughout the preceding 31 day period.

18. A staff member from the premises who is conversant with the operation of the CCTV system shall be on the premises at all times when the premises is open to the public. This staff member shall be able to show Police recent data or footage with the absolute minimum of delay when requested.
19. The supply of alcohol shall only be to a person seated taking a table meal there and for consumption by such a person as ancillary to their meal.
20. There shall be no sales of alcohol for consumption off the premises.
21. Challenge 21 signage shall be displayed in a prominent position upon entering the premises.
22. Substantial food and non-intoxicating beverages, including drinking water, shall be available in all parts of the premises where alcohol is sold or supplied for consumption on the premises.
23. The supply of alcohol shall be by waiter or waitress service only.
24. No draft beers or lagers shall be sold.
25. There shall be no self-service of alcohol on the premises.
26. Patrons temporarily leaving the premises shall not take drinks with them.
27. No noise shall emanate from the premises nor vibration be transmitted through the structure of the premises which gives rise to a nuisance.

Environmental Health have proposed this condition be replaced with the following:

No noise generated on the premises, or by its associated plant or equipment, shall emanate from the premises nor vibration be transmitted through the structure of the premises which gives rise to a nuisance.

28. Notices shall be prominently displayed at all exits requesting patrons to respect the needs of local residents and leave the area quietly.
29. Notices shall be prominently displayed at any area used for smoking requesting patrons to respect the needs of local residents and use the area quietly.
30. Loudspeakers shall not be located in the entrance lobby or outside the premises building.
31. The entrance door shall be kept closed after 23:00 hours, or at any time when regulated entertainment takes place, except for the immediate access and egress of persons.

32. All waste shall be properly presented and placed out for collection no earlier than 30 minutes before the scheduled collection times.
33. No rubbish, including bottles, shall be moved, removed or placed in outside areas between 2300 hours and 0800 hours.
34. The pavement from the building line to the kerb edge immediately outside the premises, including gutter/channel at its junction with the kerb edge, shall be swept and or washed, and litter and sweepings collected and stored in accordance with the approved refuse storage arrangements.

Environmental Health have proposed this condition be replaced with the following:

During the hours of operation of the premises, the licence holder shall ensure sufficient measures are in place to remove and prevent litter or waste arising or accumulating from customers in the area immediately outside the premises, and that this area shall be swept and or washed, and litter and sweepings collected and stored in accordance with the approved refuse storage arrangements by close of business.

35. No deliveries of stock are to be received between 23:00 and 08:00.

Conditions proposed by the Police

36. A minimum of 1 SIA licensed door supervisor shall be on duty at the premises from 23.00hrs until close on Thursday, Friday and Saturday evenings.
37. An incident log shall be kept at the premises, and made available on request to an authorised officer of the City Council or the Police, which will record the following:
 - (a) all crimes reported to the venue
 - (b) all ejections of patrons
 - (c) any complaints received concerning crime and disorder
 - (d) any incidents of disorder
 - (e) all seizures of drugs or offensive weapons
 - (f) any faults in the CCTV system or searching equipment or scanning equipment
 - (g) any refusal of the sale of alcohol
 - (h) any visit by a relevant authority or emergency service
38. There shall be no sales of hot food or hot drink for consumption off the premises after:
00.30hrs Monday - Wednesday
01.00hrs Thursday - Saturday
00.00hrs on Sunday

Environmental Health have proposed the following alternative:

There shall be no sales of hot food or hot drink for consumption off the premises after 23.00.

39. A direct telephone number for the manager at the premises shall be publicly

available at all times the premises is open. This telephone number is to be made available to residents, relevant authority and businesses in the vicinity if requested.



27 Old Compton Street

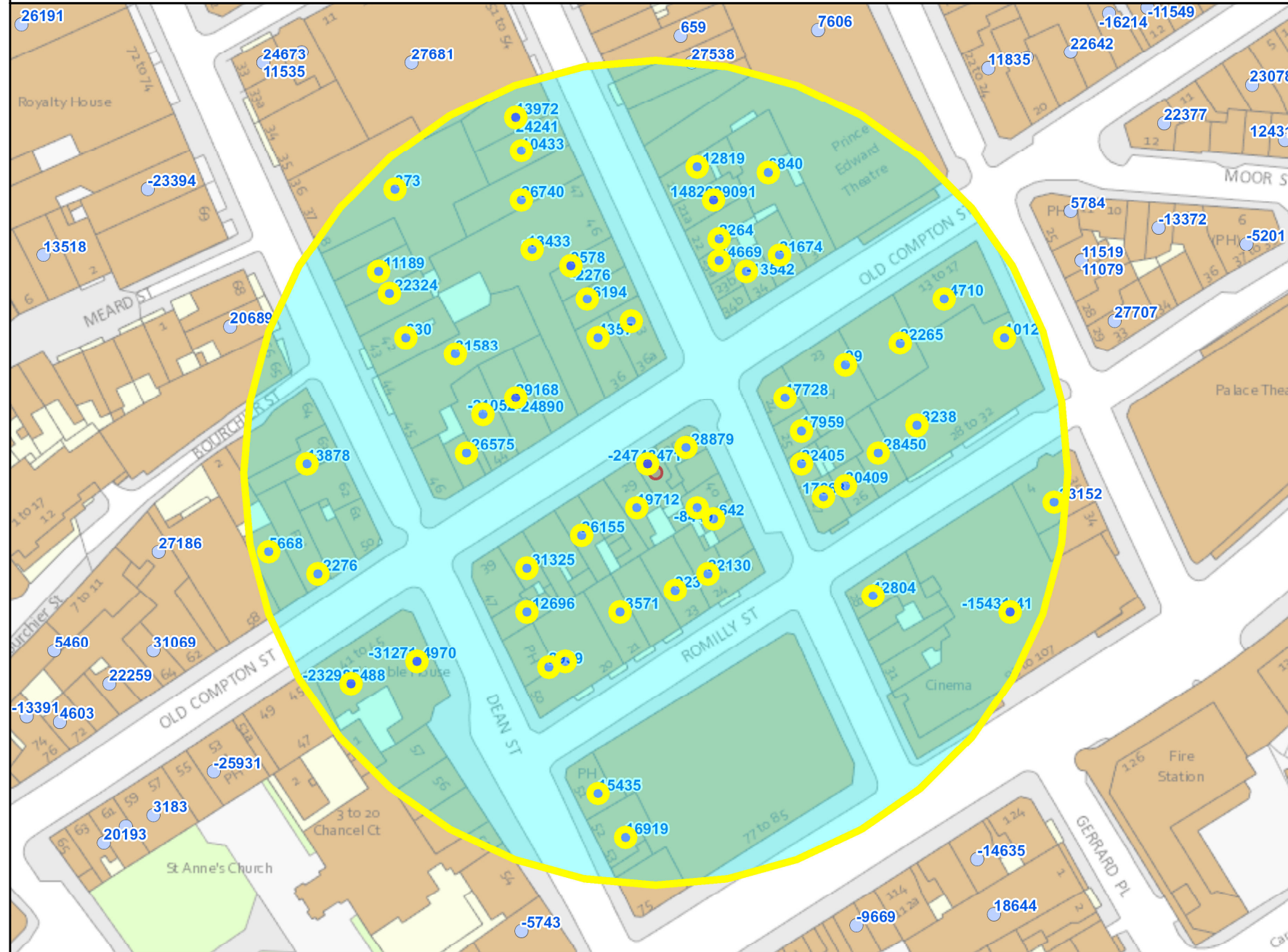

Residential Properties	165
Under Construction	Not known
Other Uses	Not known
Proportion Residential of all Uses	Not known

10
 Meters

This product includes mapping data licensed from Ordnance Survey with the permission of the Controller of Her Majesty's Stationery Office. © Crown copyright and/or database right 2013. All rights reserved. Licence number LA 100019597

Data Source: Uniform Database
 Date: 26/10/2016

Appendix 5 - Data List

Premises within 75m of: 27 Old Compton Street			
p / n	Name of Premises	Premises Address	Opening Hours
16/00627/LIPDPS	Bar Soho	23 Old Compton Street London W1D 5JL	Sunday 09:00 - 01:00 Monday to Thursday 09:00 - 01:30 Friday to Saturday 09:00 - 03:30
15/09992/LIPT	Burger & Lobster	36 - 38 Dean Street London W1D 3TE	Monday to Thursday 10:00 - 00:30 Friday to Saturday 10:00 - 01:00 Sundays before Bank Holidays 12:00 - 00:30 Sunday 12:00 - 23:00
12/03369/LIPVM	Soho House	40 Greek Street London W1D 5JJ	Sundays before Bank Holidays 09:00 - 00:00 Monday to Saturday 09:00 - 03:30 Sunday 09:00 - 23:00
13/07402/LIPT	Bar Italia	Basement And Ground Floor Front 22 Frith Street London W1D 4RP	Monday to Saturday 10:00 - 05:00 Sunday 12:00 - 05:00
06/05786/WCCMAP	Tuk Tuk	Basement And Ground Floor 56 Old Compton Street London W1D 4UN	Monday to Saturday 10:00 - 00:30 Sunday 12:00 - 00:00
09/01147/LIPV	G-A-Y Bar	Basement To First Floor 30 Old Compton Street London W1D 4TP	Sunday 09:00 - 00:30 Monday to Saturday 09:00 - 01:30
16/08550/LIPCCT	ZIMA Russian Street Food And Bar	45 Frith Street London W1D 4SD	Monday to Saturday 10:00 - 01:00 Sunday 12:00 - 00:00
15/06965/LIPN	Blade Soho	26 Frith Street London W1D 5LE	Monday to Saturday 10:00 - 22:00 Sunday 12:00 - 20:00
16/00095/LIPDPS	Compton News	48 Old Compton Street London W1D 4UA	Monday to Saturday 07:00 - 01:00 Sunday 08:00 - 22:00
08/09144/LIPD	The Vintage House	Basement And Ground Floor 42 Old Compton Street London W1D 4TX	Monday to Saturday 08:00 - 23:00 Sunday 10:00 - 22:30
06/06018/WCCMAP	Y Ming	35-36 Greek Street London W1D 5DN	Monday to Saturday 10:00 - 00:30 Sunday 12:00 - 00:00
13/09939/LIPDPS	Patisserie Valerie	44 Old Compton Street London W1D 4TY	Monday to Saturday 10:00 - 00:30 Sunday 12:00 - 00:00
13/06021/LIPDPS	Genting Casino London China Town	First Floor Wingate House 93 - 107 Shaftesbury Avenue London W1D 5DY	Monday to Sunday 00:00 - 23:59
15/08372/LIPRW	Balans Cafe	34 Old Compton Street London W1D 4TP	Monday to Saturday 10:00 - 05:00 Sunday 12:00 - 05:00
11/01841/LIPDPS	Ronnie Scott's Jazz Club	Basement And Ground Floor And Part First Floor 47 Frith Street London W1D 4SE	Sunday 09:00 - 00:30 Monday to Saturday 09:00 - 03:30
12/07791/LIPVM	Rosa's	Ground Floor And Basement 48 Dean Street London W1D 5BF	Monday to Saturday 10:00 - 23:30 Sunday 12:00 - 23:00
13/04147/LIPDPS	40 Dean Street	40 Dean Street London W1D 4PX	Monday to Saturday 10:00 - 00:30 Sunday 12:00 - 00:00
13/04050/LIPDPS	Dozo	Basement And Ground Floor 40 Frith Street London W1D 5LN	Monday to Saturday 10:00 - 00:30 Sunday 12:00 - 00:00
06/12560/WCCMAP	The Delhi Brasserie	44 Frith Street London W1D 4SB	Monday to Saturday 10:00 - 00:30 Sunday 12:00 - 00:00
15/04626/LIPDPS	Cafe Boheme	Basement And Ground Floor 13 - 17 Old Compton Street London W1D 5JH	Monday to Saturday 09:00 - 05:00 Sunday 12:00 - 00:00
16/00056/LIPCCH	&Pasta	60 Dean Street London W1D 6AW	Monday to Thursday 07:00 - 00:00 Friday to Saturday 07:00 - 00:30 Sunday 07:00 - 23:00
15/08418/LIPT	Admiral Duncan Public House	54 Old Compton Street London W1D 4UD	Friday to Saturday 10:00 - 00:00 Monday to Thursday 10:00 - 23:30 Sunday 12:00 - 22:30
12/00868/LIPVM	Assa	23 Romilly Street London W1D 5AQ	Monday to Saturday 10:00 - 00:30 Monday to Saturday 10:00 - 23:30 Sunday 12:00 - 00:00 Sunday 12:00 - 23:00
09/06680/LIPVM	French House Public House	49 Dean Street London W1D 5BG	Monday to Saturday 10:00 - 00:30 Sunday 12:00 - 00:00
16/08715/LIPCCT	Wok On Fire	43 Old Compton Street London W1D 6HG	Sunday 11:00 - 00:00 Monday to Thursday 11:00 - 01:00 Friday to Saturday 11:00 - 02:00

16/03145/LIPDPS	Opuz Kitchen	Basement And Ground Floor 27 Old Compton Street London W1D 5JP	Monday to Wednesday 08:00 - 00:30 Thursday to Saturday 08:00 - 01:00 Sunday 10:00 - 00:00
16/03642/LIPCHT	Hoppers	49 Frith Street London W1D 4SG	Monday to Saturday 10:00 - 00:30 Sunday 12:00 - 23:30
08/11517/LIPD	Gerry's Club	Basement 52-53 Dean Street London W1D 5BJ	Monday to Saturday 10:00 - 03:30 Sunday 12:00 - 23:00
15/11650/LIPDPS	Belgo	29-31 Old Compton Street London W1D 5JR	Monday to Saturday 10:00 - 00:30 Sunday 12:00 - 00:00
08/06508/LIPDPS	The Arts Theatre Club	Ground Floor West 50 Frith Street London W1D 4SQ	Monday to Saturday 09:00 - 03:30 Sunday 09:00 - 23:00
13/04926/LIPDPS	Herman Ze German	Basement And Ground Floor 33 Old Compton Street London W1D 5JU	Friday to Saturday 11:00 - 00:00 Sunday 11:00 - 22:30 Monday to Thursday 11:00 - 23:30
16/03521/LIPDPS	Top Dog Eats	Basement And Ground Floor 48 Frith Street London W1D 4SF	Friday to Saturday 10:00 - 00:00 Monday to Thursday 10:00 - 23:30 Sundays before Bank Holidays 12:00 - 00:00 Sunday 12:00 - 22:30
12/06841/LIPV	Soho Whisky Club	First Floor 42 Old Compton Street London W1D 4TX	Friday to Saturday 10:00 - 00:00 Sunday 10:00 - 22:00 Monday to Thursday 10:00 - 23:00
13/07476/LIPDPS	The Groucho Club	44-45 Dean Street London W1D 4QB	Monday to Saturday 09:00 - 02:30 Sunday 12:00 - 00:00
14/00825/LIPDPS	Pulcinella Restaurant	Basement To First Floor 37 Old Compton Street London W1D 5JY	Monday to Saturday 10:00 - 00:30 Sunday 12:00 - 00:00
16/03523/LIPN	Smack Soho	Kemble House 58 Dean Street London W1D 6AL	Monday to Saturday 12:00 - 22:00
16/00621/LIPDPS	Hotel Chocolat	25 Old Compton Street London W1D 5JN	Friday to Saturday 10:00 - 00:00 Sunday 10:00 - 22:30 Monday to Thursday 10:00 - 23:00
06/07048/WCCMAP	Cho Won Korean Restaurant	27 Romilly Street London W1D 5AL	Monday to Saturday 10:00 - 00:30 Sunday 12:00 - 00:00
09/06572/LIPN	Amorino	41 Old Compton Street London W1D 6HF	Monday to Saturday 12:00 - 01:00 Sunday 12:00 - 23:00
11/08882/LIPDPS	Duck Soup	Basement And Ground Floor 41 Dean Street London W1D 4PY	Monday to Saturday 10:00 - 00:30 Sunday 12:00 - 00:00
15/11265/LIPRW	Le Relais De Venise L'Entrecote	50 Dean Street London W1D 5BQ	Monday to Saturday 09:00 - 03:30 Sunday 12:00 - 00:00
06/06142/WCCMAP	Little Italy	21 Frith Street London W1D 4RN	Monday to Sunday 09:00 - 05:00
12/02725/LIPDPS	Gauthier At Lindsay House	21 Romilly Street London W1D 5AF	Friday to Saturday 10:00 - 00:00 Sunday 10:00 - 22:30 Monday to Thursday 10:00 - 23:30
11/06536/LIPDPS	Kettners	29 Romilly Street London W1D 5HP	Monday to Saturday 10:00 - 01:30 Sunday 12:00 - 00:00
16/04918/LIPCHT	Pepe Italian Street Food	Basement And Ground Floor 27 Old Compton Street London W1D 5JP	Monday to Wednesday 08:00 - 00:30 Thursday to Saturday 08:00 - 01:00 Sunday 10:00 - 00:00
15/01004/LIPDPS	Buffo	45 Frith Street London W1D 4SD	Monday to Saturday 10:00 - 01:00 Sunday 12:00 - 00:00
15/01285/LIPDPS	Buen Gusto Cafe	39 Frith Street London W1D 5LL	Monday to Sunday 06:00 - 03:00
15/05952/LIPDPS	Curzon Soho Cinema	93-107 Shaftesbury Avenue London W1D 5DY	Sunday 09:00 - 00:00 Monday to Saturday 09:00 - 02:30
11/00852/LIPDPS	Cay Tre (Soho)	42-43 Dean Street London W1D 4QA	Monday to Sunday 09:30 - 01:30
15/05523/LIPDPS	Muriel's Kitchen	36 Old Compton Street London W1D 4TT	Monday to Sunday 07:00 - 01:30
16/06874/LIPDPS	Bar Shu	28 Frith Street London W1D 5LF	Sunday 11:00 - 00:00 Monday to Saturday 11:00 - 00:30

12/03653/LIPDPS	Tonkotsu	Basement To First Floor 63 Dean Street London W1D 4QG	Monday to Saturday 10:00 - 00:30 Sunday 12:00 - 00:00
13/03570/LIPV	Koya Bar	Ground Floor 50 Frith Street London W1D 4SQ	Friday to Saturday 10:00 - 00:00 Monday to Thursday 10:00 - 23:30 Sunday 12:00 - 22:30
15/03256/LIPCHT	Muse Soho	Basement 23 Frith Street London W1D 4RR	Sunday 09:00 - 01:00 Monday to Saturday 09:00 - 04:00
13/07404/LIPT	Little Italy	21A Frith Street London W1D 4RW	Monday to Sunday 09:00 - 05:30
16/07026/LIPCH	Golden Lion Public House	51 Dean Street London W1D 5BH	Friday to Saturday 07:00 - 00:00 Sunday 07:00 - 00:00 Monday to Saturday 07:00 - 00:30 Sunday 07:00 - 23:00 Monday to Thursday 07:00 - 23:30
15/02220/LIPV	Bistro 1	27 Frith Street London W1D 5LE	Sunday 08:00 - 00:00 Monday to Saturday 08:00 - 01:00
06/05092/WCCMAP	Dodo Supermarket	Basement And Ground Floor 24 Frith Street London W1D 5LA	Monday to Thursday 08:00 - 01:00 Friday to Saturday 08:00 - 03:00 Sunday 10:00 - 22:30
16/03879/LIPDPS	Ku Bar	Basement To First Floor 25 Frith Street London W1D 5LB	Friday to Saturday 10:00 - 00:00 Sundays before Bank Holidays 10:00 - 00:00 Sunday 10:00 - 22:30 Monday to Thursday 10:00 - 23:30
13/04738/LIPVM	Dozo	Basement To First Floor 32 Old Compton Street London W1D 4TP	Monday to Saturday 10:00 - 01:30 Sunday 12:00 - 00:00
13/07472/LIPDPS	BA Shan Restaurant	24 Romilly Street London W1D 5AH	Monday to Saturday 12:00 - 00:00 Sunday 12:00 - 23:30
15/04634/LIPDPS	Soho Kitchen And Bar	19-21 Old Compton Street London W1D 5JJ	Monday to Sunday 00:00 - 00:00
06/06245/WCCMAP	Little Italy Two	Ground Floor 21A Frith Street London W1D 4RF	Monday to Saturday 10:00 - 05:00 Sunday 12:00 - 05:00
13/00218/LIPN	Kyoto	26 Romilly Street London W1D 5AJ	Monday to Saturday 10:00 - 00:30 Sunday 12:00 - 00:00
06/06241/WCCMAP	Caffe Nero	Ground Floor 43 Frith Street London W1D 4SA	Sunday to Wednesday 23:00 - 02:00 Thursday to Saturday 23:00 - 04:00

If you have any queries about this report or wish to inspect one of the background papers please contact the report author.

Background Documents – Local Government (Access to Information) Act 1972

1	Licensing Act 2003	N/A
2	City of Westminster Statement of Licensing Policy	7 th January 2016
3	Amended Guidance issued under section 182 of the Licensing Act 2003	March 2015
4	Application form	13 September 2016
5	Current licence	16 May 2016